

USE AND FUNCTION

Assembling vacuum cleaner

Note:

Always remove the power plug from the wall outlet before assembling or removing accessories.

1. Attaching the Flexible Hose into the vacuum. Connect the flexible hose into the air intake duct; push in until you hear a “click” sound, indicating it is in its locked position.



2. Fitting the tube to the curved wand/hose extension. Push the tube into the curved wand/hose extension.
3. Fitting the floor brush to the tube. Push the tube into the floor brush. Adjust the tube to the desired length.

BUTTON FUNCTION INTRODUCTION

Note:

Once all attachments are in place, unwind a sufficient length of cable and insert the plug into the wall outlet. A yellow mark on the power cord shows the ideal cable length. Do not pull the power cord beyond the red mark.

1. Insert the power plug into the wall outlet.
2. Press the on/off & speed control button located on the unit to turn the vacuum cleaner “on”. To adjust the suction, rotate the button to control the suction power of the vacuum cleaner.
3. To rewind the power cord, press the cord rewind button with one hand and guide the power cord with the other hand to ensure that it does not whip causing damage or injury.

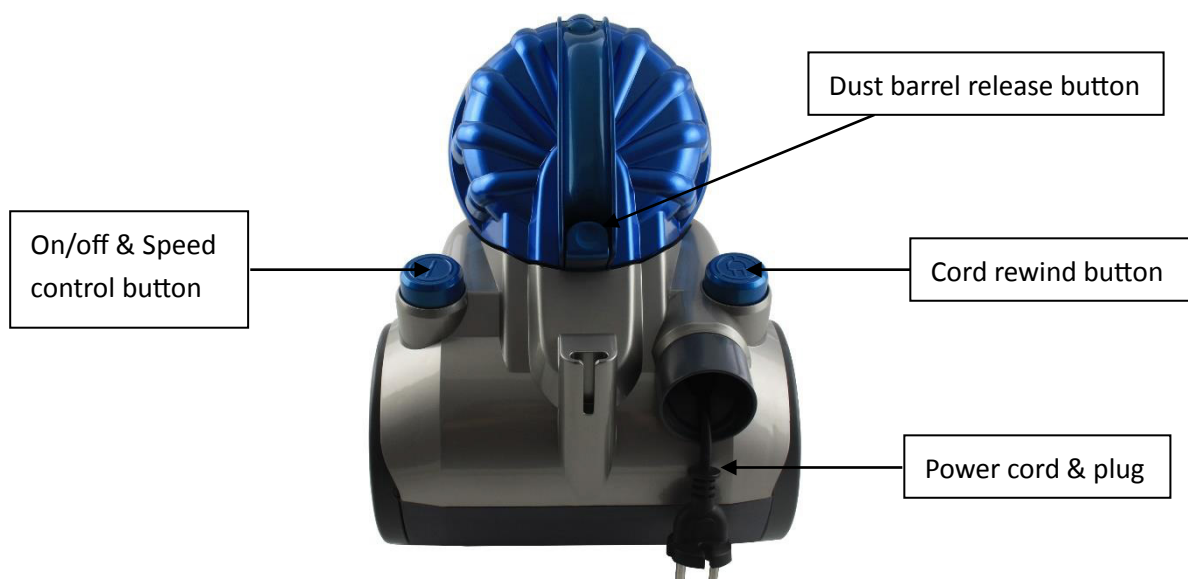

CLEAN THE DUST BARREL

1. Press the knob on the dust cup arm.
2. Lift dust barrel up.
3. Press knob on low end of dust barrel to open the dust barrel cover.



Removing & cleaning pre-motor filter, centric Hepa filter, and air outlet filter

Warning: Always unplug the unit from electrical outlet before getting out the dust barrel.

a. Pre-motor filter

1. Press the knob on the dust cup arm.
2. Lift dust barrel up.
3. Take out the pre-motor filter for cleaning and changing.



Tips: how to detach the upper part from the dust barrel

1. Find the lock icons on the side of the upper part of the dust barrel. The mark "I" is pointing at the locked one.
2. Turn the upper part anti-clockwise and the mark "I" will be pointing at the unlocked icon; then lift.

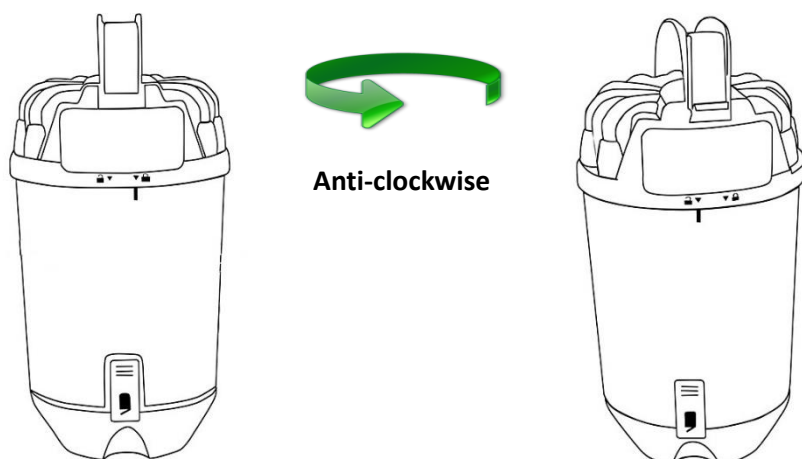

b. dual filter

1. Press the knob on the dust cup arm.
2. Lift dust barrel up.
3. Apart the dual filter and dust cup by referring the lock markings as above.
4. Use a soft brush to clean the dual filter then rinse it with clean water, dry it before replace it.

Note: please take the pre-motor filter out before rinse the dual filter.



c. Air outlet filter

1. Take out the dust barrel from the vacuum cleaner as above.
2. Turn the appliance over to open the air outlet filter cap.
3. Take out the air outlet filter for cleaning and changing.



Please note:

The Hepa filter in the cleaner will become dusty over time. This is normal and will not affect the performance of the filter. If the Hepa filter is so dusty that suction does not return to 100%, we suggest that the filter be removed then rinsed under the faucet and allowed to dry for 24 hours by airing not near the fire or some high temperature objects before refitting into the vacuum. This should be done once six months or when suction appears to be reduced obviously.

Important:

Please note that there is a safety switch inside the vacuum to prevent the unit from being run with high vacuum rate. If the vacuum is too high, the safety switch will be turned on. In this case, it can minimize the vacuum rate and protect the motor from being broken.

Note:

The suction hole must be open, free of any obstructions at all times. Otherwise, the motor will overheat and could become damaged.